

GPIB BOARD ACCESSORIES

GPIB CONNECTOR ADDRESS SWITCH ASSEMBLIES

DESCRIPTION

ICS's GPIB Connector/Address Switch Assemblies are the convenient and easy way to mount a GPIB Connector and an Address Rocker switch on the rear panel of a chassis. Each GPIB Connector/Address Switch Assembly is a small business card sized PC board assembly with a metal shell GPIB connector, an eight position rocker switch and a flat ribbon cable. The GPIB Connector/Address Switch Assembly is held on to the rear panel by the two metric studs that are used on the IEEE 488 connector. The flat ribbon cable carrying the address and GPIB signals, plugs into a header on the GPIB interface card or other ICS module. Cable length may be specified by the user to fit this chassis.

Two Configurations

The GPIB Connector/Address Switch Assemblies are available in two configurations. In the Horizontal configuration the address switch is to the right of the IEEE 488 connector as seen from the rear of the chassis. In the Vertical configuration, the Address switch is mounted above the IEEE 488 connector. Figures 1 and 2 show the dimensions for both configurations. The assemblies can be turned 90° if required to fit the available rear panel space. Both configurations only use 0.532 inches (13.51 mm) of depth behind the panel

Variable Cable Length

The GPIB Connector/Address Switch Assemblies have connectors pressed on the ends of the flat ribbon cable. The standard length (L) for both versions is 90 cm (36 inches). The dash number is the cable length in cm. GPIB Connector/Address Switch Assemblies can be ordered to any length cable from 10 to 90 cm. Standard stocked lengths are: 30, 45, 60 and 90 cm. Best practise is to order a length close to the needed length. Coiling up the extra cable length just makes the system more vulnerable to RFI noise.



Vertical Connector/Address Switch Assembly (left) and Horizontal Connector/Address Switch Assembly (right)

Easy Panel Machining

The GPIB Connector/Address Switch Assembly only requires two cutouts on the rear panel, a rectangular one for the address switch and a 'D' cutout for the connector. The cutouts for both configurations shown in Figures 3 and 4. The supplied metric studs, which hold the assembly to the rear panel, are designed to be used with an 0.022 inch thick lockwasher and an 0.048 inch (1.22 mm) thick panel. Thicker panels may have to be countersunk.

Figure 5 shows the suggested silkscreen artwork for most applications. Check the interface card's manual for the correct use of the switch rockers before silkscreening the rear panel.

Dual Connector Versions

The GPIB Connector/Address Switch Assemblies are also available with two plugs on the flat ribbon cable. This gives the user a way to control two GPIB Interface cards from one GPIB connector on the rear panel of the chassis. Both configurations are available with dual ribbon connectors. The Dual Connector versions do not have the Address Switch installed on the printed circuit board since each board has its own GPIB address which is saved on the board. The cutouts for the Dual Connector versions are the same as for the single connector versions except they do not have the Address Switch cutout. See Figures 6 and 7 on page 3

- GPIB Connector and Address Switch Assembly mounts on rear panel and plugs into the Interface Card.
Saves cost of building your own PC board and cable.
- Flat ribbon cable comes in user specified lengths up to 90 cm long.
Get the length you need
- Only requires two cutouts and two holes on the rear panel.
Easy machining and assembly.
- Two configurations to choose from.
Fits most rear panels.
- Includes metric studs for the IEEE 488 connector.
Nothing else to buy.
- New Dual Connector versions connects two boards to one GPIB connector.
Only one rear panel GPIB connector on the test chassis.



7034 Commerce Circle
Pleasanton, CA 94588
Phone: 925.416.1000
Fax: 925.416.0105
Web: www.icselect.com

SPECIFICATIONS

Assembly Drawings

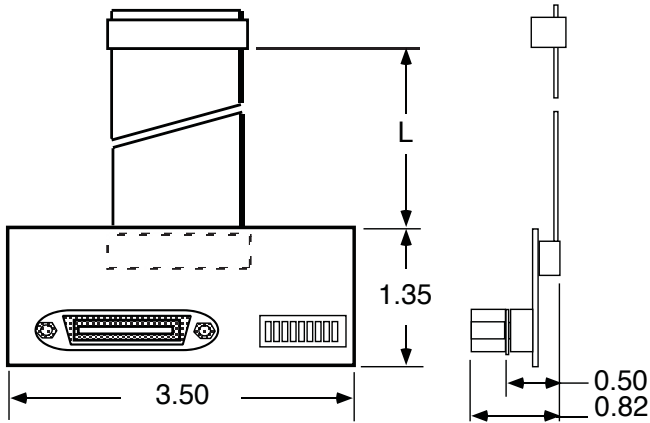

Dark line denotes BRN1 wire

Figure 1 Horizontal Connector/Address Switch Assembly

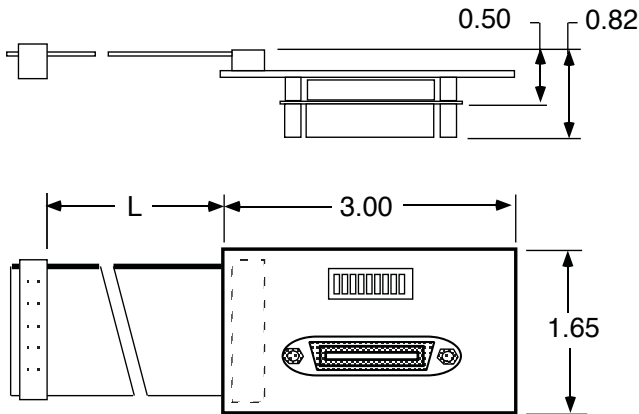

Dark line denotes BRN1 wire

Figure 2 Vertical Connector/Address Switch Assembly

Rear Panel Cutouts

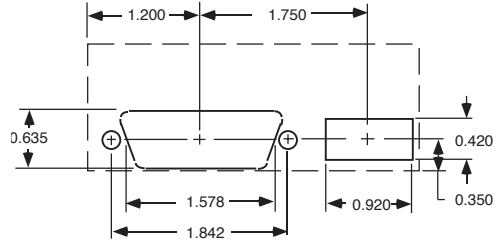
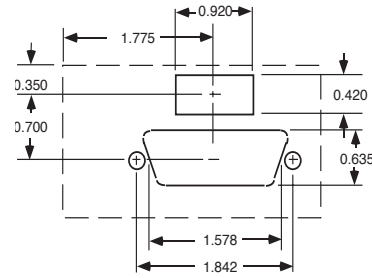
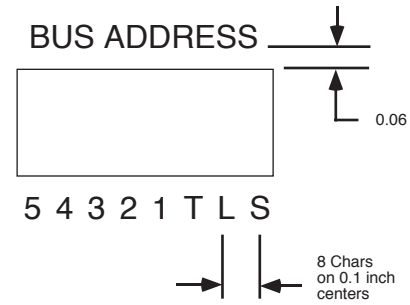

Figure 3 Horizontal Connector/Address Switch Cutouts



- Notes:
1. All dimensions are in inches
 2. D cutout radius is 0.2 inches
 3. Holes are 0.180 dia., 2 plcs
 4. Allow 0.25 inches for cable bend radius

Figure 4 Vertical Connector/Address Switch Cutouts



- NOTES: Center legends over opening
All letters are Helvetica Medium, 0.1 high

Figure 5 Silk Screen Detail

Note: Cable length L can be 10 to 90 cm. Standard stocked lengths are: 30, 45, 60 and 90 cm.

ORDERING INFORMATION

	Part Number
Horizontal GPIB Connector-Switch Assembly with the flat ribbon connector	113640-L
Horizontal GPIB Connector-Switch Assembly with the flat ribbon connector-without the switch, 90 cm long	113649-90
Vertical GPIB Connector-Switch Assembly with the flat ribbon connector	113642-L

SPECIFICATIONS

Dual Connector Versions

Figures 6 and 7 show the Dual Connector Assemblies and the two connectors. The user specifies lengths L1 and L2 in cm when ordering. L1 and L2 should not exceed 90 cm.

Connector Wiring

The table below shows the signal assignments on the flat ribbon plug. Plug layout is shown in Figure 8. Use a 3M P/N N2526-5002RB or equivalent PCB Connector on the PC Board.

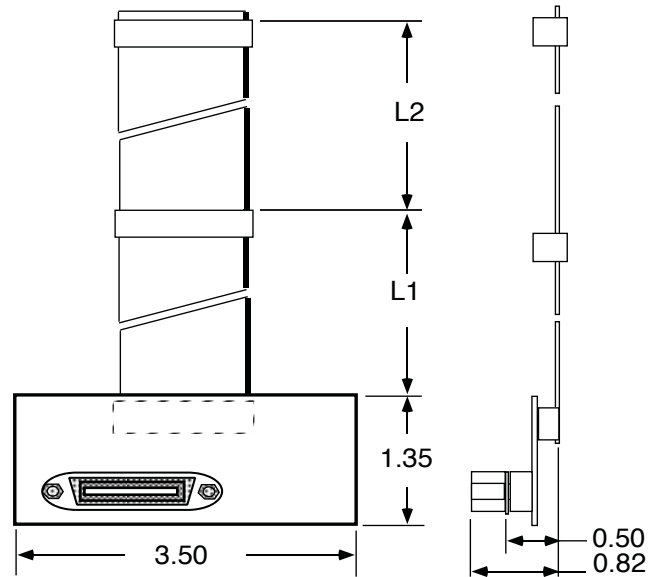

Dark line denotes BRN1 wire

Figure 6 Horizontal Dual Connector Assembly

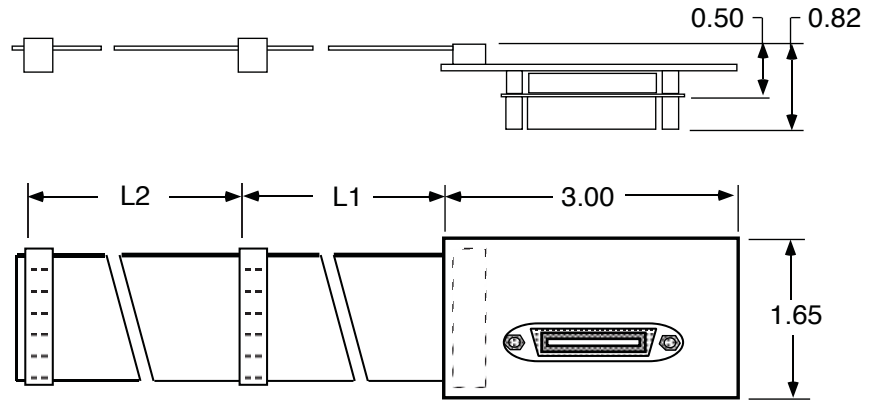

Dark line denotes BRN1 wire

Figure 7 Vertical Dual Connector Assembly

Signal	Pin Number	Wire Color	Address Weights
GROUND	1	BRN 1	
ADSW5	2	RED 1	16 (MSB)
T SW	3	ORG 1	not used
L SW	4	YEL 1	not used
ADSW4	5	GRN 1	8
SI SW	6	BLU 1	0
ADSW1	7	VIO 1	1
ADSW3	8	GRY 1	4
ADSW2	9	WHT 1	2
NRFD	10	BLK 1	
REN	11	BRN2	
DAV	12	RED 2	
IFC	13	ORG 2	
NDAC	14	YEL 2	
EOI	15	GRN 2	
ATN	16	BLU 2	
SRQ	17	VIO 2	
DIO1	18	GRY 2	
DIO2	19	WHT 2	
DIO3	20	BLK 2	
DIO4	21	BRN 3	
DIO5	22	RED 3	
DIO6	23	ORG 3	
DIO7	24	YEL 3	
DIO8	25	GRN 3	
GROUND	26	BLU 3	

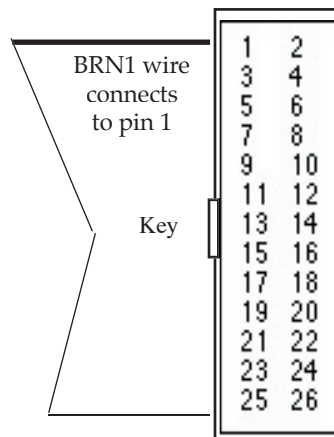

View looking down on the PC board.

Plug 3M 3399-6000 mates to 3M P/N N2526-5002RB or equivalent PCB Connector

Figure 8 Flat-ribbon Plug Layout

ORDERING INFORMATION

Horizontal GPIB Connector-Switch Assembly with two flat ribbon connectors

Part Number

113646-L1-L2

Vertical GPIB Connector-Switch Assembly with two flat ribbon connectors

113647-L1-L2